

SET-UP

INSTRUCTIONS

Pop-Up Express



Remove the frame with the graphic attached from the case. Place it on the floor with the fabric facing upward. If the display has end caps (fabric covering the two sides) be sure that they are NOT attached to the Velcro® strapping located along the sides. If your display does not have endcaps, disregard and proceed to step 2.

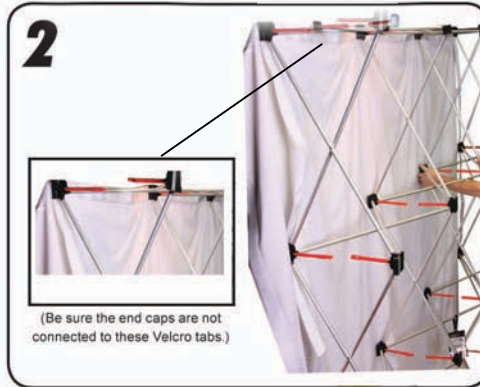

Stand the display upright, and begin to expand the frame by pulling up and outward. If any resistance is met STOP. Before continuing, check to be sure that the end caps are free and not stuck to the Velcro® strapping or tabs. DO NOT FORCE THE FRAME UP. Continue pulling until the frame is fully expanded.

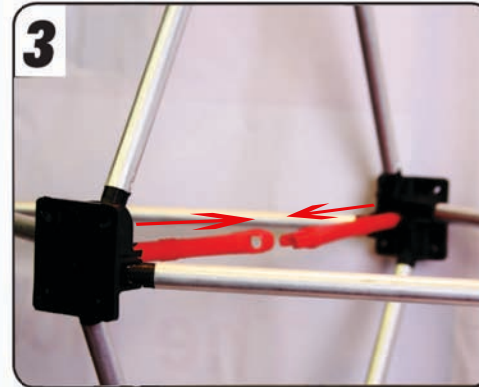

To lock the frame in place, engage the red locks until they snap into a locked position.

(Note: Depending on the positioning of the fabric or level of the floor not all magnets may engage. This does not affect the stability or aesthetics of the display.)

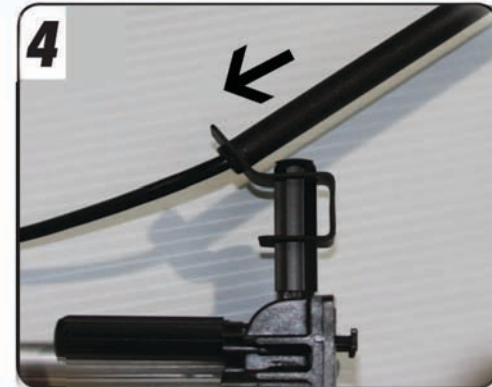

Flip the posts attached to the frame top to an upright position. Slide the lights on to the post until they stop.



If the display has end caps, pull them around the sides of the frame and attach them to the Velcro® tabs.

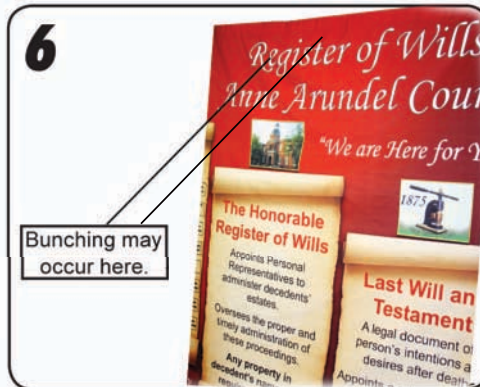

Bunching of the fabric may occur where the graphic meets the plastic hubs at the top and bottom of the frame. In order to eliminate bunching simply reposition the graphic as shown in step seven and eight.

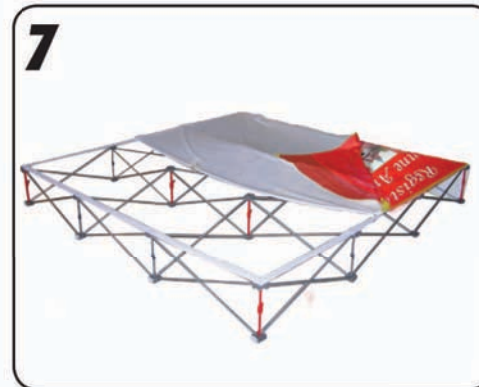

To reposition the fabric lay the display on floor face up. Peel back the fabric on one side to the approximate center point.

(Note: Be sure to remove the lights from the display prior to laying the display on the floor.)



Reapply the fabric while pulling it straight all the way to end along both the top and bottom. Repeat motion on the opposite side as well. Stand the display upright.

DISMANTLE INSTRUCTIONS

Pop-Up Express

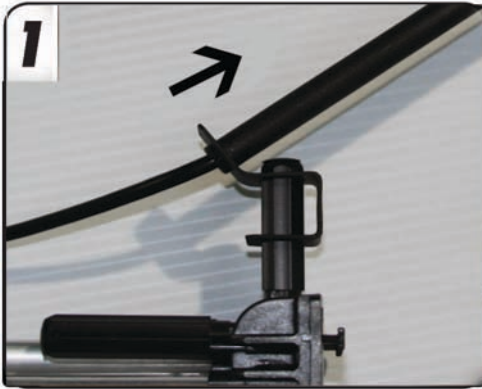

1 Unplug the lights. Carefully slide the lights off the posts. Flip down posts before packing.



2 If the display has end caps, release the fabric from the rear Velcro® tabs along both sides of the display. Be sure that the end caps are not connected to any portions of the Velcro® before continuing.

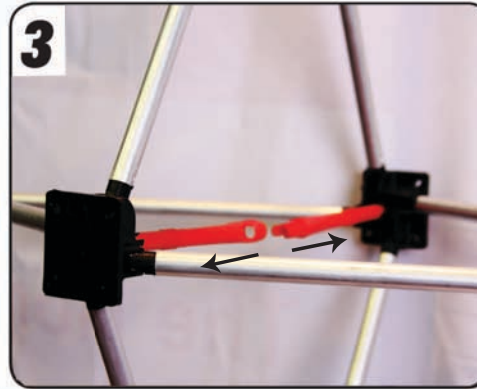

3 Release all of the red locks on the frame by squeezing the release tab. Make sure that they do not clip back together.

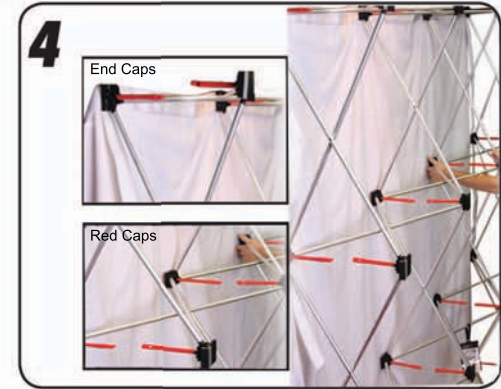

4 From the back of the display give the frame a slight tug to disengage the magnets. **DO NOT FORCE THE FRAME.** If the display does not collapse recheck the end caps and the red locks to be sure that they are not connected.



5 Collapse the display down approximately 50% of the way setting it fabric side up.



6 Evenly tuck the fabric in between the frame. Be sure that the end caps are not connected to the Velcro® straps or tabs.



7 To return the display to its case, remove the liner from the case. Slide display into the liner.



8 Pick up the display with the liner surrounding it and slide both into the bag. Place the light fixtures into the front portion of the bag.